

Technical data

- 1.Nominal voltage: 300V/15A  
PITCH:5.0mm
- 2.Connection capacity:  
AWG 24-12
3. Insulation Withstands Voltage:  
AC 1600V/MIN
4. Insulation Resistance:  
1000M $\Omega$  or more at DC500V
5. Tightening torque:  
4.0kgf.cm (3.5LB-in / 0.4N.m)
6. Screw thread: M2.5
7. Stripping length: 6-7mm
8. Using temperature range: -40C ~ 115C°  
Soldering temperature: 250 $\pm$ 10C°/5s
9. Undimmed stoned Tolerances:

|                            |                         |       |
|----------------------------|-------------------------|-------|
| Dim L=P $\times$ 5.08      | Dim B                   | Dim L |
| Dim B=(P-1) $\times$ 5.08  | 0-30mm<br>+0.15         | +0.20 |
| P= number of poles (2-24p) | over 30mm-60mm<br>+0.20 | +0.25 |
|                            | over 60mm-90mm<br>+0.25 | +0.30 |
|                            | over 90mm<br>+0.30      | +0.40 |

10. Safety approval:
11. RoHS Compliance
12. Critical dimension:

EHAM508 xxx X xxx

- ① Poles 02-24
- ② Color

- 0 Black 2 Red 3 Orange 4 Yellow 5 Green
- 6 Blue 8 Dark Gray G Pale gray .....
- ③ Custom
- 000 K MARK 00K KUNACON MARK .....

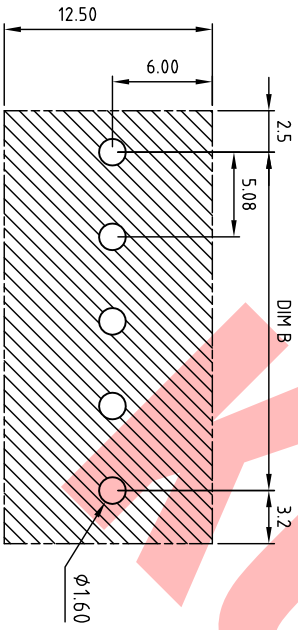

|   |             |      |      |
|---|-------------|------|------|
| △ | DESCRIPTION | CHK. | DATE |
|   |             |      |      |
|   |             |      |      |

|          |           |              |                               |          |                             |        |        |               |
|----------|-----------|--------------|-------------------------------|----------|-----------------------------|--------|--------|---------------|
| 4        | CONTACT   | BRASS        | Tin PLATED                    | P        |                             |        |        |               |
| 3        | SCREW     | STEEL        | M2.5 $\times$ 0.45, Zn Plated | P        |                             |        |        |               |
| 2        | CAGE      | BRASS        | M2.5 $\times$ 0.45, NI PLATED | P        |                             |        |        |               |
| 1        | BODY      | PA66 UL94V-0 | ALL COLOR                     | 1        |                             |        |        |               |
| MATERIAL |           |              |                               |          |                             |        |        |               |
| DWG.     | WF. Zhang | DATE         | 2018.05.21                    | UNITS:   | MM                          | SHEET: | 1 OF 1 | Tolerance     |
| CHK.     | WF. Zhang | DATE         | 2018.05.21                    | SCALE:   | NONE 3:1 (.)                | REV.:  | A      |               |
| APP.     | DATE      |              |                               | TITLE:   | EH-AM508 Series Solid block |        |        |               |
|          |           |              |                               |          | type "-" slot screw type    |        |        |               |
|          |           |              |                               | PART NO. | EHAM508xxxxxx               |        |        |               |
|          |           |              |                               | DWG NO.  | EH-A508-B001                |        |        |               |
|          |           |              |                               |          |                             |        |        | Tolerance     |
|          |           |              |                               |          |                             |        |        | +0.50         |
|          |           |              |                               |          |                             |        |        | +0.30         |
|          |           |              |                               |          |                             |        |        | +0.10         |
|          |           |              |                               |          |                             |        |        | $\pm$ 1 $\mu$ |