

Technical data

- 1.Nominal voltage: 300V/10A
PITCH:3.81mm
 - 2.Connection capacity:
AWG 30-16
 - 3. Insulation Withstanding Voltage:
AC 1600V/MIN
 - 4. Insulation Resistance:
1000MΩ or more at DC500V
 - 5. Tightening torque:
2-2.5kgf.cm (0.2-0.25N.m)
 - 6. Screw thread: M2
 - 7. Stripping length: 5-6mm
 - 8. Using temperature range: -40C°-115C°
Soldering temperature: 250±10C°/5S
 - 9. Undimensioned Tolerances:
Dim L=(P-1)x3.81+4.56
Dim B=(P-1)x3.81
P = number of poles(2-24P)

	Dim B	Dim L
0-30mm	±0.15	±0.20
over 30mm-60mm	±0.20	±0.25
over 60mm-90mm	±0.25	±0.30
over 90mm	±0.30	±0.40

 - 10. Safety approval:
 - 11. RoHS Compliance
 - 12. Critical dimension:
- EBHS381 xx X Axx
 ① Poles 02-24
 ② Color
 0 Black 3 Orange 5 Green 6 Blue 8 Gray....
 ③ Custom
 A00 K MARK A0K KUNACON MARK

P.C.B. LAYOUT

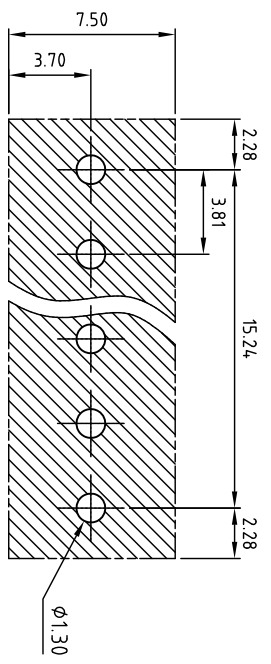

REV	Δ	DESCRIPTION	CHK	DATE

ITEM	NAME OF PART	MATERIAL	NOTES
4	CONTACT	BRASS	Tin PLATED
3	SCREW	STEEL	M2, Zn Plated
2	CAGE	BRASS	M2, Ni PLATED
1	BODY	PA66 UL94V-0	ALL COLOR

DWG	WF. Zhang	DATE	2018.07.18	UNITS	MM	SHEET:	1 OF 1
CHK.	WF. Zhang	DATE	2018.07.25	SCALE:	NONE 5:1 (.)	REV.:	A
APP.	DATE	DATE		TITLE:	EB-HS381 Series " " Slot		
				PART NO.	EBHS381xxxxxx		
				DWG NO.	EB-H381-B001		



KUNA Contact Technology Co. Ltd
<http://www.kunacon.com>

